

Profile

| | | | |
|-------------------------|--|-------------------------|------------------------|
| Parcel: | 589905009 | DOR Use Code: | 5375 |
| Alternate ID: | | DOR Description: | SOD FARM (RURAL BAHIA) |
| Address: | GRASS FARM RD PALMETTO 34221 | Land Acres: | 302.0610 |
| Owner Details: | MCZ CENTRUM FLORIDA IX LLC | NBHD: | 1600 |
| | | Subdivision No. | 0000000 |
| Mailing Address: | 225 WEST HUBBARD ST CHICAGO IL 60610 | Subdivision Name | |
| | | Topography: | |
| Description: | BEG AT NE COR OF SEC 4-33S-18E; TH | T/R/S: | 33S / 18E / 04 |
| | | Tax District: | 0001 |
| | | Utilities: | |
| | | Zoning: | PDMU |

Value Summary

| | | | | | |
|---------------------------|----------------|------------------------------|--------------|-------------------------------|--------------|
| Just Land Value: | \$4,984,007.00 | Total Assessed Value: | | Amend 10 Savings: | \$0.00 |
| Just Improv. Value | \$0.00 | Exemptions Value: | \$0.00 | Total Taxes: | \$8,989.14 |
| Total Just Value: | \$4,984,007.00 | Total Taxable Value: | \$510,483.00 | Total Appraised Value: | \$510,483.00 |

Primary Residential Card

| | | |
|------------------------|--------------------------------|-------------------------|
| Card: | Total Bedrooms: | Area Under Roof: |
| Stories: | Full Bath: | Electric: |
| Heating Class: | Half Bath: | Exterior Wall: |
| Heating Fuel: | Family Rooms: | Flooring: |
| Physical Cond.: | Wood Burning Fireplace: | Interior: |
| CDU: | Fireplace Openings: | Plumbing: |
| Year Built: | Grade: | Roof Material: |
| Year Remodeled: | Percent Complete: | Roof Type: |
| Total Rooms: | SFLA: | |

Commercial Card

| | |
|------------------------|---------------------------|
| Year Built: | Grade: |
| Effective Year: | Exterior Wall: |
| Units: | Flooring: |
| Structure Code: | Class: |
| Description: | Class Description: |

Land

| Land Code | Eff. Front | Eff. Depth | Land Type | Acres |
|-----------|------------|------------|-----------|----------|
| 540 | | | Acres | 302.0610 |

Agriculture

| Soil | Soil/Crop Description | Acres |
|-------|-------------------------|----------|
| SDPSA | SOD FARM,PROF,ST AUG | 302.0610 |

Other Items

| Code | Description | Year Built | Square Ft. |
|------|-------------|------------|------------|
|------|-------------|------------|------------|

Sales History

| Date | Book-Page | Grantor | Grantee | Description | QUAL | Amount |
|-------------|-------------|---------------------|------------------------|-------------|------|------------|
| 25-MAY-2004 | 1931 - 3671 | GRASS FARM RD LLC | CARGOR PARTNERS V - | Vacant | 00 | 5,100,000 |
| 21-JAN-2003 | 1799 - 0509 | MANFULL, WILLAIM L | GRASS FARM ROAD LLC | Vacant | 00 | 2,700,000 |
| 10-NOV-2005 | 2076 - 5109 | CARGOR PARTNERS V - | MCZ CENTRUM FLORIDA IX | Vacant | 02 | 35,055,900 |

Sketch

Map

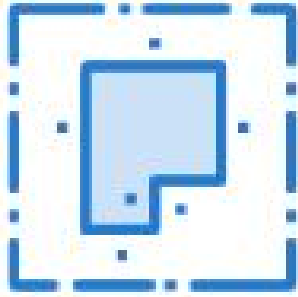

Sorry, no sketch available
for this record

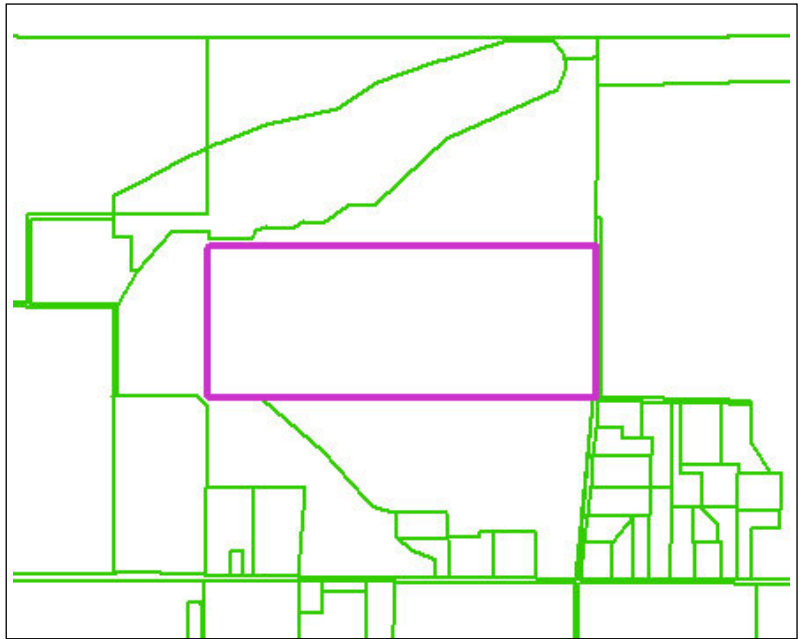

Profile

| | | | |
|-------------------------|--|-------------------------|-------------------------------|
| Parcel: | 590203009 | DOR Use Code: | 6001 |
| Alternate ID: | | DOR Description: | GRAZING, CLASS I IMPROVEMENTS |
| Address: | 4500 BUCKEYE RD PALMETTO 34221 | Land Acres: | 291.5080 |
| Owner Details: | MCZ CENTRUM FLORIDA IX LLC | NBHD: | 1600 |
| | | Subdivision No. | 0000000 |
| Mailing Address: | 225 WEST HUBBARD ST CHICAGO IL 60610 | Subdivision Name | |
| | | Topography: | |
| Description: | BEG AT SE COR OF SEC 4, TWN 33S, RNG | T/R/S: | 33S / 18E / 04 |
| | | Tax District: | 0001 |
| | | Utilities: | |
| | | Zoning: | PDMU |

Value Summary

| | | | | | |
|---------------------------|----------------|------------------------------|--------------|-------------------------------|--------------|
| Just Land Value: | \$4,809,882.00 | Total Assessed Value: | | Amend 10 Savings: | \$0.00 |
| Just Improv. Value | \$19,660.00 | Exemptions Value: | \$0.00 | Total Taxes: | \$4,370.24 |
| Total Just Value: | \$4,829,542.00 | Total Taxable Value: | \$213,754.00 | Total Appraised Value: | \$213,754.00 |

Primary Residential Card

| | | |
|------------------------|--------------------------------|-------------------------|
| Card: | Total Bedrooms: | Area Under Roof: |
| Stories: | Full Bath: | Electric: |
| Heating Class: | Half Bath: | Exterior Wall: |
| Heating Fuel: | Family Rooms: | Flooring: |
| Physical Cond.: | Wood Burning Fireplace: | Interior: |
| CDU: | Fireplace Openings: | Plumbing: |
| Year Built: | Grade: | Roof Material: |
| Year Remodeled: | Percent Complete: | Roof Type: |
| Total Rooms: | SFLA: | |

Commercial Card

| | |
|------------------------|---------------------------|
| Year Built: | Grade: |
| Effective Year: | Exterior Wall: |
| Units: | Flooring: |
| Structure Code: | Class: |
| Description: | Class Description: |

Land

| Land Code | Eff. Front | Eff. Depth | Land Type | Acres |
|-----------|------------|------------|-----------|----------|
| 540 | | | Acres | 291.5080 |

Agriculture

| Soil | Soil/Crop Description | Acres |
|-------|-----------------------|----------|
| RWCRP | ROW CROP | 122.38 |
| AGLND | AGRICULTURAL LAND | 169.1280 |

Other Items

| Code | Description | Year Built | Square Ft. |
|------|-------------|------------|------------|
|------|-------------|------------|------------|

Sales History

| Date | Book-Page | Grantor | Grantee | Description | QUAL | Amount |
|-------------|-------------|----------------|------------------------|-------------|------|-----------|
| 27-OCT-2004 | 1984 - 5454 | GRASS FARMS LC | GRASS FARMS LC | Improved | 01 | 1 |
| 10-NOV-2005 | 2076 - 5109 | GRASS FARMS LC | MCZ CENTRUM FLORIDA IX | Improved | 02 | 35,055,90 |
| 01-JUN-2004 | 1931 - 3669 | REEDER RANCH & | GRASS FARMS LC | Improved | 00 | 2,948,10 |

Sketch

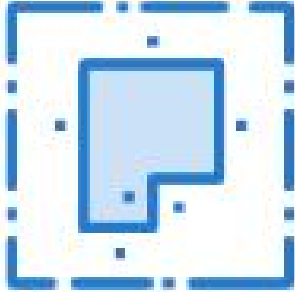

Sorry, no sketch available for this record

Map

ERROR RETRIJVING DATA



Sorry, no map available for this record

Profile

| | | | |
|-------------------------|--|-------------------------|------------------|
| Parcel: | 590204609 | DOR Use Code: | 6000 |
| Alternate ID: | | DOR Description: | GRAZING, CLASS I |
| Address: | GRASS FARM RD PALMETTO 34221 | Land Acres: | 4.28 |
| Owner Details: | MCZ CENTRUM FL IX LLC | NBHD: | 1600 |
| | | Subdivision No. | 0000000 |
| Mailing Address: | 225 W HUBBARD ST 4TH FL CHICAGO IL 60610 | Subdivision Name | |
| | | Topography: | |
| Description: | BEG AT THE NE COR OF SEC 4; TH RUN S | T/R/S: | 33S / 18E / 04 |
| | | Tax District: | 0001 |
| | | Utilities: | |
| | | Zoning: | A |

Value Summary

| | | | | | |
|---------------------------|-------------|------------------------------|------------|-------------------------------|------------|
| Just Land Value: | \$62,830.00 | Total Assessed Value: | | Amend 10 Savings: | \$0.00 |
| Just Improv. Value | \$0.00 | Exemptions Value: | \$0.00 | Total Taxes: | \$64.28 |
| Total Just Value: | \$62,830.00 | Total Taxable Value: | \$2,140.00 | Total Appraised Value: | \$2,140.00 |

Primary Residential Card

| | | |
|------------------------|--------------------------------|-------------------------|
| Card: | Total Bedrooms: | Area Under Roof: |
| Stories: | Full Bath: | Electric: |
| Heating Class: | Half Bath: | Exterior Wall: |
| Heating Fuel: | Family Rooms: | Flooring: |
| Physical Cond.: | Wood Burning Fireplace: | Interior: |
| CDU: | Fireplace Openings: | Plumbing: |
| Year Built: | Grade: | Roof Material: |
| Year Remodeled: | Percent Complete: | Roof Type: |
| Total Rooms: | SFLA: | |

Commercial Card

| | |
|------------------------|---------------------------|
| Year Built: | Grade: |
| Effective Year: | Exterior Wall: |
| Units: | Flooring: |
| Structure Code: | Class: |
| Description: | Class Description: |

Land

| Land Code | Eff. Front | Eff. Depth | Land Type | Acres |
|-----------|------------|------------|-----------|-------|
| 546 | | | Acres | 4.28 |

Agriculture

| Soil | Soil/Crop Description | Acres |
|-------|-----------------------|-------|
| AGLND | AGRICULTURAL LAND | 4.28 |

Other Items

| Code | Description | Year Built | Square Ft. |
|------|-------------|------------|------------|
|------|-------------|------------|------------|

Sales History

| Date | Book-Page | Grantor | Grantee | Description | QUAL | Amount |
|-------------|-------------|--------------------|-----------------------|-------------|------|---------|
| 10-NOV-2005 | 2076 - 5113 | KNOWLES, TIMOTHY A | MCZ CENTRUM FL IX LLC | Vacant | 00 | 182,700 |
| 07-AUG-2006 | 2145 - 3040 | KNOWLES, TIMOTHY A | KNOWLES, TIMOTHY A | Vacant | 01 | 1 |

Sketch

Map

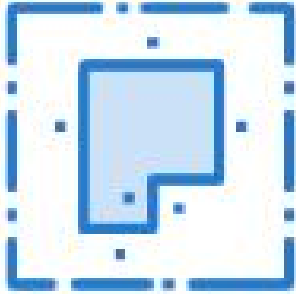

Sorry, no sketch available
for this record

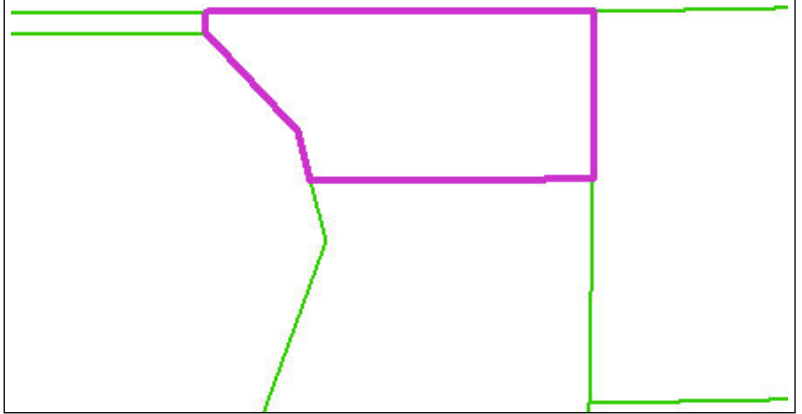

Profile

| | | | |
|-------------------------|--|-------------------------|--------------------|
| Parcel: | 603400109 | DOR Use Code: | 0000 |
| Alternate ID: | | DOR Description: | VACANT RESIDENTIAL |
| Address: | BUCKEYE RD PALMETTO 34221 | Land Acres: | 1.1160 |
| Owner Details: | MCZ/CENTRUM FLORIDA IX LLC | NBHD: | 1600 |
| | | Subdivision No. | 0000000 |
| Mailing Address: | 225 W HUBBARD ST 4TH FL CHICAGO IL 60610 | Subdivision Name | |
| | | Topography: | |
| Description: | COM AT E1/4 COR OF SEC 9 TWN 33S RNG | T/R/S: | 33S / 18E / 09 |
| | | Tax District: | 0001 |
| | | Utilities: | |
| | | Zoning: | A |

Value Summary

| | | | | | |
|---------------------------|------------|------------------------------|------------|-------------------------------|------------|
| Just Land Value: | \$2,087.00 | Total Assessed Value: | | Amend 10 Savings: | \$0.00 |
| Just Improv. Value | \$0.00 | Exemptions Value: | \$0.00 | Total Taxes: | \$44.03 |
| Total Just Value: | \$2,087.00 | Total Taxable Value: | \$2,087.00 | Total Appraised Value: | \$2,087.00 |

Primary Residential Card

| | | |
|------------------------|--------------------------------|-------------------------|
| Card: | Total Bedrooms: | Area Under Roof: |
| Stories: | Full Bath: | Electric: |
| Heating Class: | Half Bath: | Exterior Wall: |
| Heating Fuel: | Family Rooms: | Flooring: |
| Physical Cond.: | Wood Burning Fireplace: | Interior: |
| CDU: | Fireplace Openings: | Plumbing: |
| Year Built: | Grade: | Roof Material: |
| Year Remodeled: | Percent Complete: | Roof Type: |
| Total Rooms: | SFLA: | |

Commercial Card

| | |
|------------------------|---------------------------|
| Year Built: | Grade: |
| Effective Year: | Exterior Wall: |
| Units: | Flooring: |
| Structure Code: | Class: |
| Description: | Class Description: |

Land

| Land Code | Eff. Front | Eff. Depth | Land Type | Acres |
|-----------|------------|------------|-----------|--------|
| 518 | | | Acres | 1.1160 |

Agriculture

| Soil | Soil/Crop Description | Acres |
|------|-----------------------|-------|
|------|-----------------------|-------|

Other Items

| Code | Description | Year Built | Square Ft. |
|------|-------------|------------|------------|
|------|-------------|------------|------------|

Sales History

| Date | Book-Page | Grantor | Grantee | Description | QUAL | Amount |
|-------------|-------------|----------------|------------------------|-------------|------|--------|
| 15-JUL-2008 | 2268 - 0168 | REEDER RANCH & | MCZ/CENTRUM FLORIDA IX | Vacant | 00 | 33,800 |
| 15-JUL-2008 | 2269 - 1522 | MCZ/CENTRUM | MCZ/CENTRUM FLORIDA IX | Vacant | 01 | 1 |

Sketch

Map

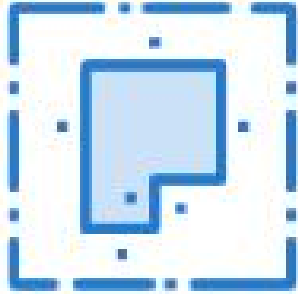

Sorry, no sketch available
for this record

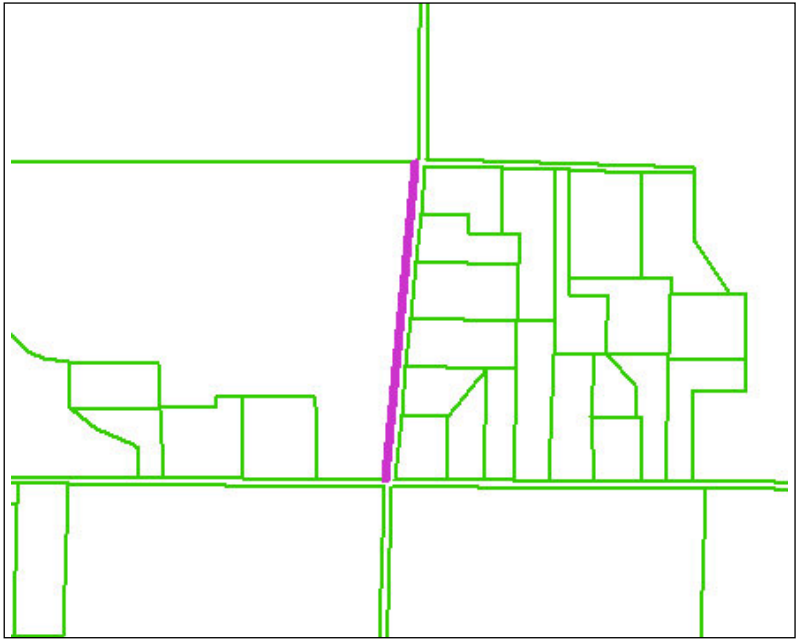

Profile

| | | | |
|-------------------------|--|-------------------------|--------------------|
| Parcel: | 603402059 | DOR Use Code: | 5200 |
| Alternate ID: | | DOR Description: | CROPLAND, CLASS II |
| Address: | BUCKEYE RD PALMETTO 34221 | Land Acres: | 177.3630 |
| Owner Details: | MCZ CENTRUM FLORIDA IX LLC | NBHD: | 1600 |
| | | Subdivision No. | 0000000 |
| Mailing Address: | 225 WEST HUBBARD ST CHICAGO IL 60610 | Subdivision Name | |
| | | Topography: | |
| Description: | COM AT NE COR OF SEC 9, TWN 33S, RNG | T/R/S: | 33S / 18E / 09 |
| | | Tax District: | 0001 |
| | | Utilities: | |
| | | Zoning: | PDMU |

Value Summary

| | | | | | |
|---------------------------|----------------|------------------------------|--------------|-------------------------------|--------------|
| Just Land Value: | \$2,926,490.00 | Total Assessed Value: | | Amend 10 Savings: | \$0.00 |
| Just Improv. Value | \$0.00 | Exemptions Value: | \$0.00 | Total Taxes: | \$3,372.56 |
| Total Just Value: | \$2,926,490.00 | Total Taxable Value: | \$146,850.00 | Total Appraised Value: | \$146,850.00 |

Primary Residential Card

| | | |
|------------------------|--------------------------------|-------------------------|
| Card: | Total Bedrooms: | Area Under Roof: |
| Stories: | Full Bath: | Electric: |
| Heating Class: | Half Bath: | Exterior Wall: |
| Heating Fuel: | Family Rooms: | Flooring: |
| Physical Cond.: | Wood Burning Fireplace: | Interior: |
| CDU: | Fireplace Openings: | Plumbing: |
| Year Built: | Grade: | Roof Material: |
| Year Remodeled: | Percent Complete: | Roof Type: |
| Total Rooms: | SFLA: | |

Commercial Card

| | |
|------------------------|---------------------------|
| Year Built: | Grade: |
| Effective Year: | Exterior Wall: |
| Units: | Flooring: |
| Structure Code: | Class: |
| Description: | Class Description: |

Land

| Land Code | Eff. Front | Eff. Depth | Land Type | Acres |
|-----------|------------|------------|-----------|----------|
| 540 | | | Acres | 177.3630 |

Agriculture

| Soil | Soil/Crop Description | Acres |
|-------|-----------------------|----------|
| RWCRP | ROW CROP | 147.2630 |
| AGLND | AGRICULTURAL LAND | 30.10 |

Other Items

| Code | Description | Year Built | Square Ft. |
|------|-------------|------------|------------|
|------|-------------|------------|------------|

Sales History

| Date | Book-Page | Grantor | Grantee | Description | QUAL | Amount |
|-------------|-------------|---------------------|------------------------|-------------|------|-----------|
| 10-NOV-2005 | 2076 - 5109 | CARGOR PARTNERS V - | MCZ CENTRUM FLORIDA IX | Vacant | 02 | 35,055,9C |

Sketch

Map

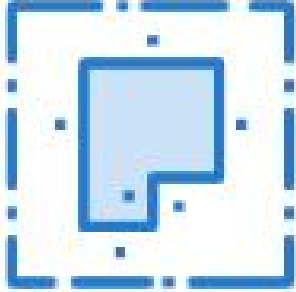

Sorry, no sketch available
for this record

